

LBB 3222 6-Channel Interpreter Desk

INTEGRUS Listen®
Digital Infrared Products

www.ListenTech.com

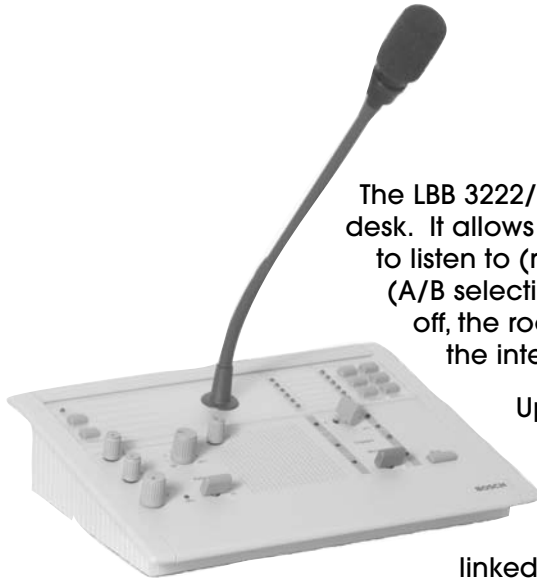

**Specify Part
Number**

LBB 3222/04

The LBB 3222/04 is a professional, full featured interpreter desk. It allows the interpreter to select the input channel to listen to (relay) and the output channel to interpret to (A/B selection). If the desk's microphone is switched off, the room audio (floor) is automatically linked to the interpretation channel.

Up to 12 desks can be daisy-chained right onto the INTEGRUS transmitter with interpretation module. No additional unit or controller required and the interpretation channels are automatically linked to the IR receiver channels.

Key Features & Benefits

- Built-in loudspeaker
- Accommodates 6 different language channels plus the original floor language
- 12 interpreter desks can be loop-through connected within and/or between interpreter booths
- Up to three interpreter desks can be present per booth
- Incoming channel pre-selector key eliminates the need to manually search through all available language channels
- Quick switching between the floor language and the channel set on the channel selector reduces the chance of operator errors
- Electronic channel interlock function prevents interpreters in different booths from using the same output channel
- Auto relay enable function allows the interpreter to provide the auto relay language (OR2) for relay interpretation
- The channel B disable function allows the interpreter to disable channel B while ensuring that the desk remains connected to channel A

Listen Technologies Corporation

8535 South 700 West, Suite A
Sandy, UT 84070-2515 U.S.A.
Phone: 1.801.233.8992 or 1.800.330.0891
Fax: 1.801.233.8995
Email: info@ListenTech.com

Don't miss a single sound.



LBB 3222 6-Channel Interpreter Desk

INTEGRUS | Listen®
Digital Infrared Products

www.ListenTech.com

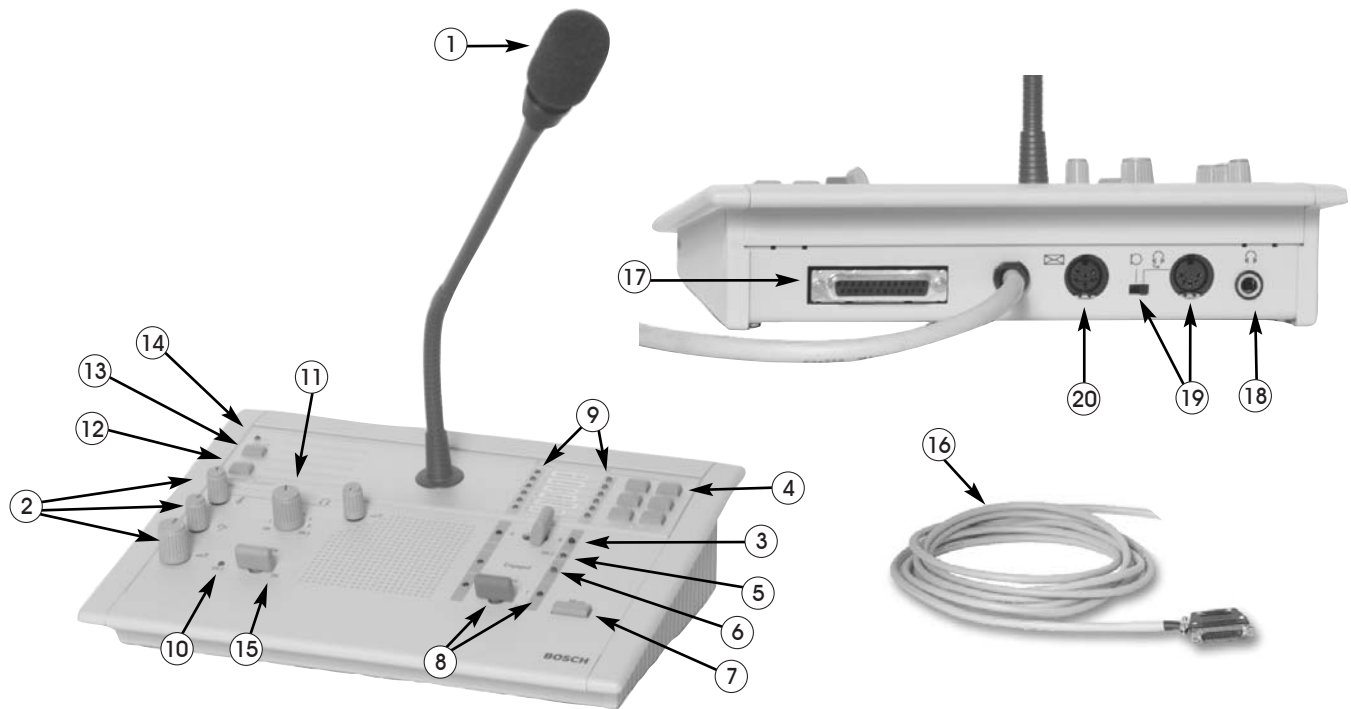

Features

1. Microphone mounted on a flexible stem, complete with a light ring which illuminates when the microphone is on
2. Headphone volume, treble and bass controls
3. A-B channel selector key with channel select indicators
4. Six outgoing B-channel select keys with channel select indicators
5. Outgoing 'OR2' (auto relay) indicator
6. 'Channel engaged' indicators to show which channels are in use by other interpreters
7. Microphone 'mute' key
8. Microphone activating key with LED status indicator
9. Select key with LED indicators for fast switching between the original floor language and the channel set on the channel selector
10. Incoming channel 'OR2' (auto relay) indicator to show that the original floor language has been replaced by a transfer interpretation channel, when the auto-relay facility is in operation
11. Incoming language channel selector for headphone monitoring
12. Call key (voice) to provide two-way communication between interpreter and chairman/operator
13. Outgoing message key
14. Incoming message indicator
15. Rotary switch to preset the outgoing channel via the A output
16. 3 m cable terminated with a 25-pin sub D-type connector
17. 25-pin sub D-type socket for loop-through connections
18. 6.3 mm (0.25 in) stereo jack headphone connectors
19. 15-pole 180° DIN-type socket for connection of interpreter's headset with microphone, plus switch to mute the built-in microphone
20. Auxiliary socket (message) for the desk's message function

Don't miss a single sound.

Listen Technologies Corporation
8535 South 700 West, Suite A
Sandy, UT 84070-2515 U.S.A.

Phone: 1.801.233.8992 or 1.800.330.0891
Fax: 1.801.233.8995
Email: info@ListenTech.com

LBB 3222 6-Channel Interpreter Desk

INTEGRUS | **Listen**[®]
Digital Infrared Products

www.ListenTech.com

Specifications

Physical	Mounting	Removable rear panel when use with Integrus transmitter
	Dimensions H x W x D	39 x 10 x 91 in. (100 x 26 x 231 mm) without front panel
	Weight	0.29 lbs. (132 g) without front panel
Electrical and Optical Characteristics	Audio input level with AGC	-16.5 dBV (150 mVeff) to +3.5 dBV (1500 mVeff)
	Audio input level without AGC	-4.4 dBV (600 mVeff)
	Asymmetric input impedance	≥ 10 k ohm
	DC input impedance	≥ 200 k ohm
System Environmental Conditions	Working conditions	Fixed/stationary/transportable
	Temperature range - transport	-40 to 158 °F (-40 to + 70 °C)
	Temperature range - operating	41 to 113 °F (+5 to + 45 °C)
	Maximum relative humidity	< 93%
	Safety	According to EN 60065, CAN/CSA-E65 (Canada and US) and UL 6500
	EMC emission	According to harmonized standard EN 55103-1 and FCC rules part 15, complying with the limits for a class A digital devices
	EMC immunity	According to harmonized standard EN 55103-2
	EMC approvals	Affixed with the CE mark
	ESD	According to harmonized standard EN 55103-2
	Mains harmonics	According to harmonized standard EN 55103-1
	Environmental requirements	Contains no banned substances as specified in UAT-0480/100 (e.g. no cadmium or asbestos)

Photographs, CAD drawings, etc. available at www.ListenTech.com.

Warranty

Most Bosch equipment carries a 3 year limited manufacturer's warranty (excluding accessories) to be free from defects in workmanship and material under normal use and conditions. Bosch rechargeable batteries carry a 1 year warranty. All Bosch accessory items carry a 90-day warranty to be free from defects in workmanship and material under normal use and conditions. Warranty does not cover normal wear and tear on the product or any other physical damage unless the damage was the result of a manufacturing defect. This warranty is void if damage occurred because of misuse or if the product has been repaired or modified by anyone other than a factory authorized service center. Contact Listen or see the Listen website for further details.

Accessories



LBB 3306/00 Integrus Interpreter Desk Extension Cable

Use this cable to connect 6-channel Integrus Interpreter Desks when standard cables are too short. 328 ft. (100 m) installation cable without connectors.



LBB 3306/20 shown

LBB 3306/05, LBB 3306/20 Integrus Interpreter Desk Extension Cable

Use this cable to connect 6-channel Integrus Interpreter Desks when standard cables are too short. Terminated with 25-pole sub-D-type plugs with a sliding-lock and pin-lock mechanisms. Available in 16 ft. (5 m) or 64 ft. (10 m) cable lengths. Includes connectors.

Don't miss a single sound.

Listen Technologies Corporation
8535 South 700 West, Suite A
Sandy, UT 84070-2515 U.S.A.

Phone: 1.801.233.8992 or 1.800.330.0891
Fax: 1.801.233.8995
Email: info@ListenTech.com